

Vessel Dilators

Highly modified forceps with elongated, parallel tips which are highly polished. Designed for controlled intraluminal vessel dilation.



Angled 10°

11 cm
Tip Ø: 0.1 mm

No. 00126-11

Tip Ø: 0.2 mm

No. 00125-11



Angled 45°

13.5 cm
Tip Ø: 0.2 mm

No. 00276-13

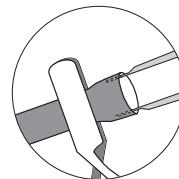

Angled 10°

12 cm
Tip Ø: 0.1 mm

No. 18131-12

Tip Ø: 0.2 mm

No. 18132-12